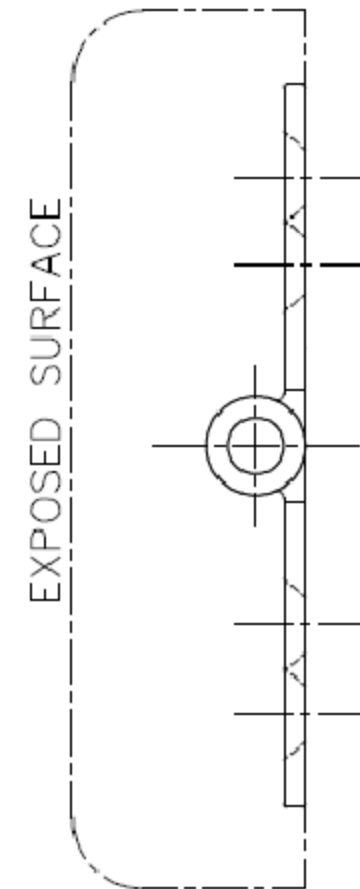
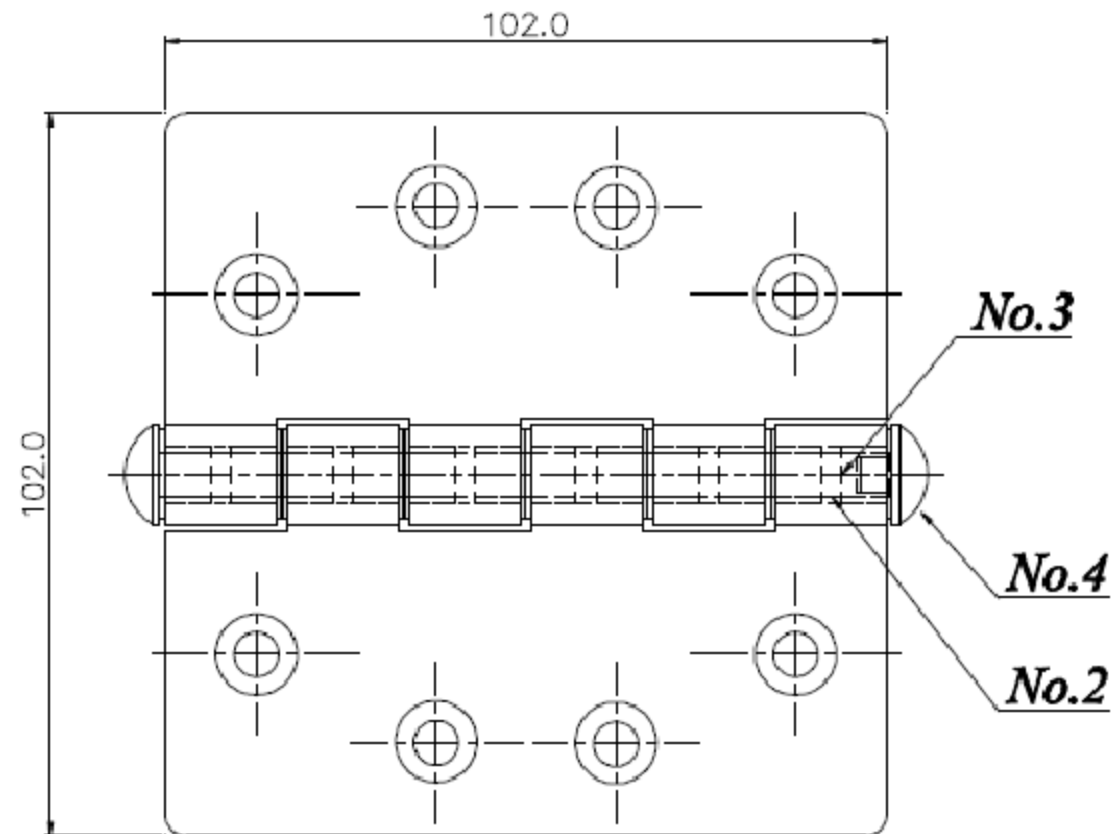

CHANGE DIMENSION PART 2

CHANGE DRAWING PART 2 , ADD DRAWING PART 4

CHANGE TITLE NAME AT PART 2,3,4

NOTE :

1. BREAK ALL SHARP EDGES
2. POLISH ON EXPOSED SURFACE

NO.	DWG. NO.	TITLE	MATERIAL	QUANTITY
1		HALF HINGE	316	2
2		PIN (OD6.35,L=103.2mm)	304	1
3		BUSHING (ID6.4)	NYLON	12
4		PIN (OD4.0,L9.50mm)	304	2

DRAWING BY :		TITLE :		
DATE : 17 FEB 2006		HINGE 4" x 4"		
CHECKED BY :		CUSTOMER :		
DATE :		REVISION	MOLD No.	MATERIAL
APPROVED BY :		C.1		
DATE :		DWG. No. :		REF. No. :
SCALE : N.T.S.				
TOLERANCE				
<input checked="" type="checkbox"/> 0	±			
<input checked="" type="checkbox"/> 0.X	± 0.25			
<input checked="" type="checkbox"/> 0.XX	± 0.13			
<input checked="" type="checkbox"/> 0.XXX	± 0.05			
<input checked="" type="checkbox"/> ANGULAR	± 0'30"			